

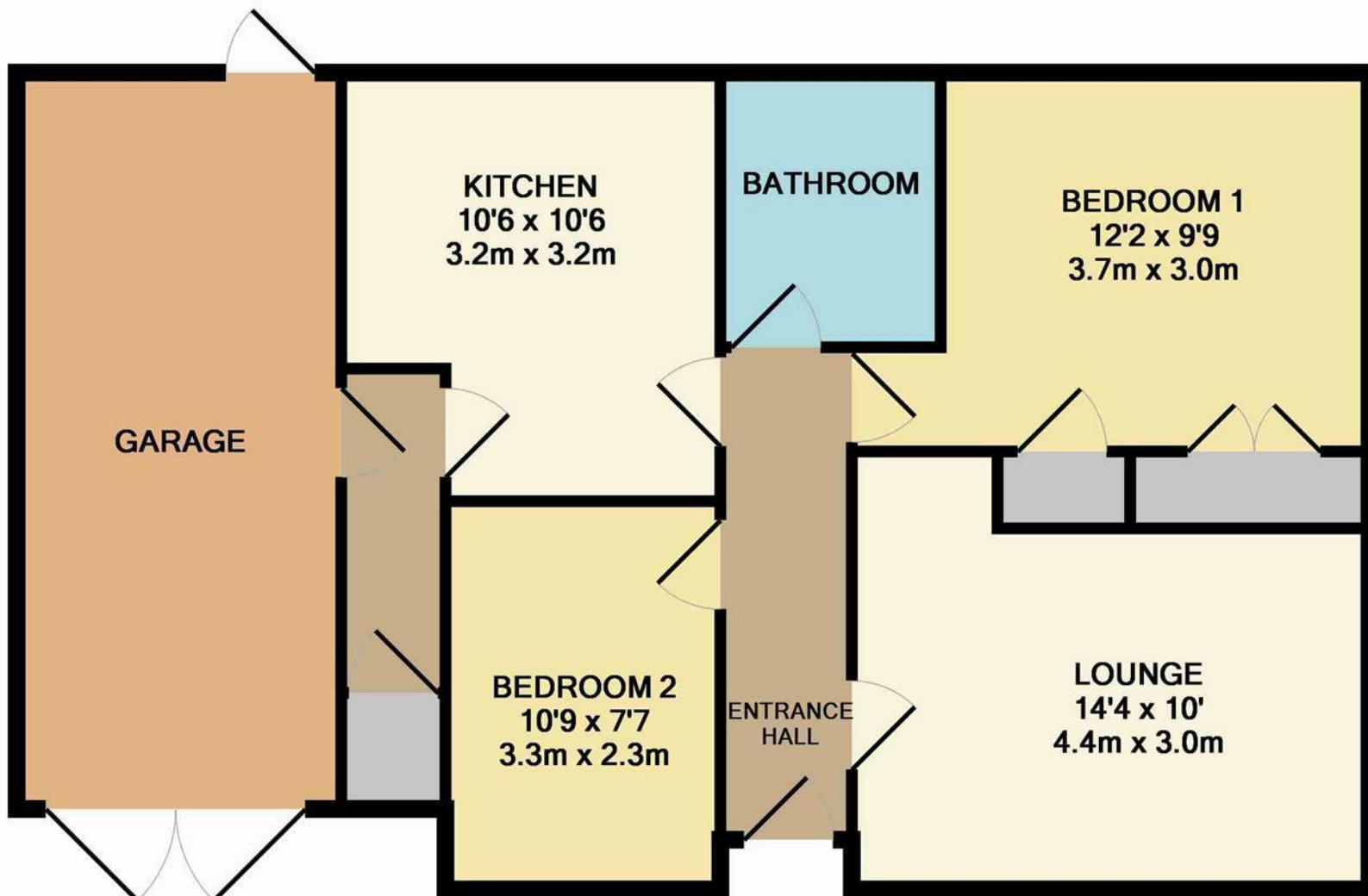

Stevens Lane | Wreningham | NR16
 Guide Price £220,000

abbotFox



Energy Efficiency Rating		Current	Potential
Very energy efficient - lower running costs			
(92 plus) A			86
(81-91) B			
(69-80) C			
(55-68) D		56	
(39-54) E			
(21-38) F			
(1-20) G			
Not energy efficient - higher running costs			
England & Wales		EU Directive 2002/91/EC	

Disclaimer – In accordance with the Property Misdescriptions Act, the company gives notice that all descriptions, references to condition, necessary permissions for use and other details are given in good faith and believed to be correct, but any intending lessees do not rely on them as statements of fact, but must satisfy themselves by inspection or other means, as to their accuracy.

Whilst every attempt has been made to ensure the accuracy of the floor plan contained here, measurements of doors, windows, rooms and any other items are approximate and no responsibility is taken for any error, omission, or mis-statement. This plan is for illustrative purposes only and should be used as such by any prospective purchaser. The services, systems and appliances shown have not been tested and no guarantee as to their operability or efficiency can be given
 Made with Metropix ©2016



Guide Price £220,000 - £230,000 abbotFox presents this two-bedroom semi-detached bungalow, offering flexible accommodation and scope to improve and extend (stpp). The property is located in a quiet cul-de-sac in the village of Wreningham with field views from all aspects. Featuring two bedrooms, wet room, kitchen and sitting room with an integral garage, as well as loft conversion potential (stpp).

Wreningham is a small village that is situated within easy access to the market town of Wymondham where there is a wide range of day to day shopping facilities as well as reputable schooling which includes Wymondham College and Wymondham High School. There is also a mainline railway station serving Cambridge and Norwich.

